

Do not operate the unit until completing these steps first

### Let's Begin!

Your customized filter will be packaged in plastic outside of the unit.  
Set the filter aside for later installation (step 6).

1. Remove the front panel by lifting from the bottom and pulling up.

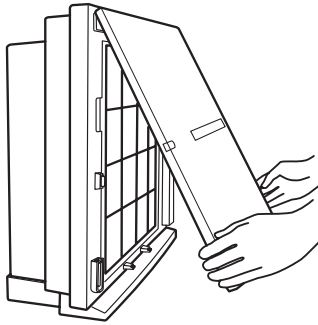

2. Remove the filter case by grasping the handles on either side and pulling forward. Lay the filter case on a flat surface.

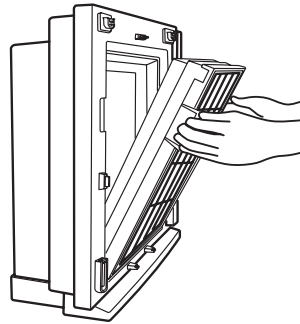

3. Pull the tabs on the front of the Pre-filter to remove it.

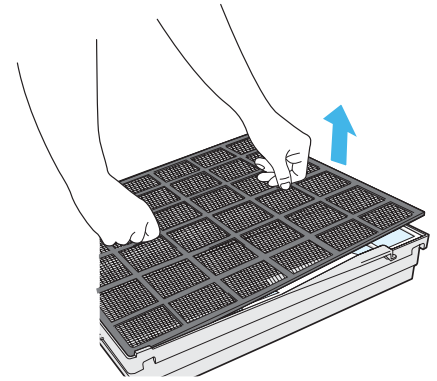

4. Remove the white Medium Filter from the black frame to discard the plastic wrapping. Return the filter to its frame.

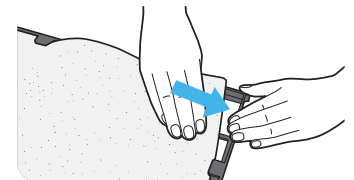
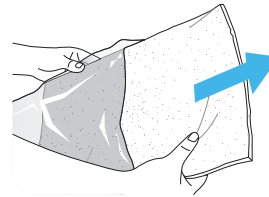
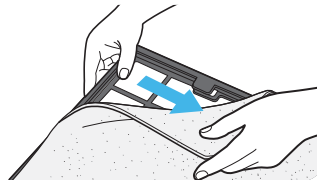
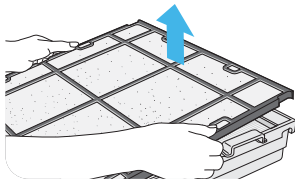

5. Remove HEPA Filter and discard plastic wrapping.

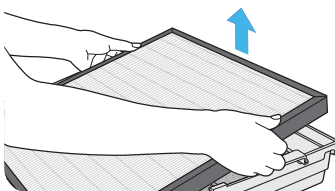

6. Remove the empty Customized Filter frame from the case. Locate the Customized Filter set aside from earlier and remove it from its plastic wrapping. Insert the filter into its frame. Make sure the front of the filter is facing up. See Customized Filter chart, below, to identify the front of your filter.

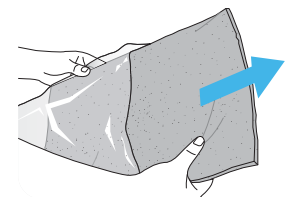
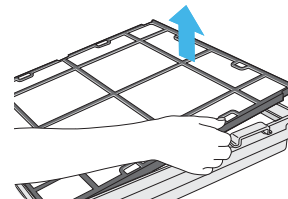

7. Pull out the Activated Carbon Filter and discard plastic wrapping.

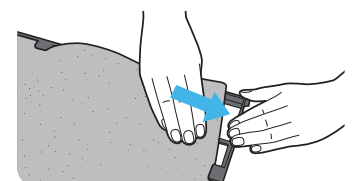
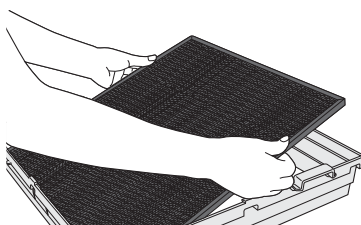

# Finishing up!

Do not operate the unit until completing these steps first

8. Return the filters to the filter case in the following order from back to front:  
Activated Carbon Filter,  
Customized Filter,  
HEPA Filter,  
Medium Filter,  
Pre-filter.  
(See diagram at right)

9. Return filter case to the unit. Slide the bottom of the case back into the unit (1), then press the top in (2).

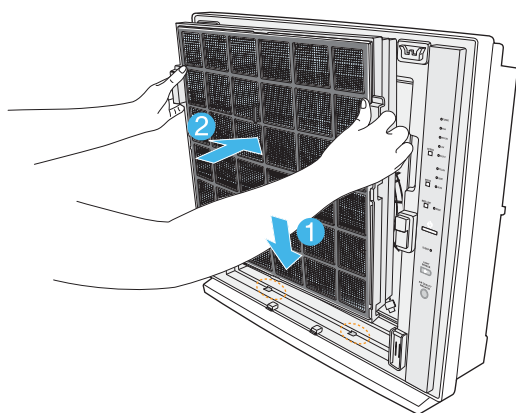

10. Reattach the front panel by latching the top hooks, then securing the bottom of the panel.

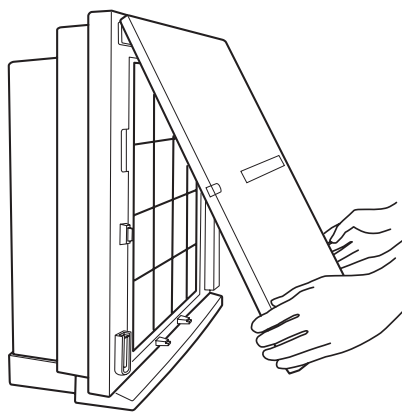

11. Filter Reset - The Replace Filters Indicator will become illuminated when it is time to change your filters. Once you have replaced the filters, press and hold the Mode/Filter Reset button for three seconds, or until the Replace Filters Indicator clears itself.

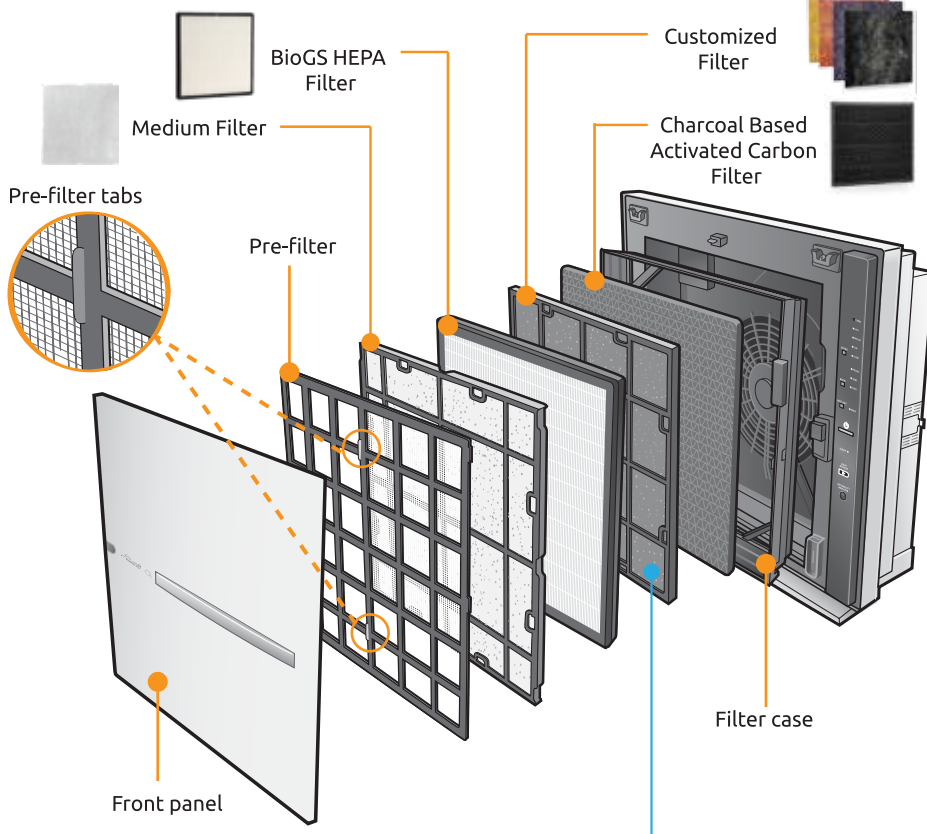
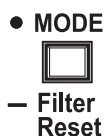

## Know your Customized Filter!

### Front



#### Toxin Absorber Customized Filter:

Front color: Purple  
Back color: Black



#### Pet Allergy Customized Filter:

Front color: Purple & Orange  
Back color: Orange



#### Germ Defense Customized Filter:

Front color: Purple & Yellow  
Back color: Yellow

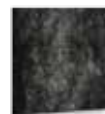

#### Odor Remover Customized Filter:

Front Color: Black (thicker fabric like material)  
Back color: Black

### Back



Scan this QR code to watch our MinusA2 filter maintenance video, or watch it online at: [www.rabbitair.com/video](http://www.rabbitair.com/video)

