

ANNUAL FILTER KIT STANDARD



Installing ET Style replacement filters in Models 2500 and 3000

Open the cabinet

1. Turn the unit off and unplug it.

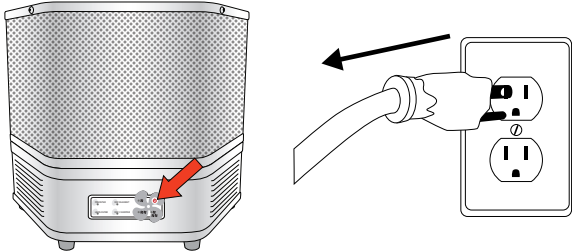

2. Unscrew the 4 lid screws with a No. 2 Phillips screw driver. Once all screws are out, remove the metal lid.

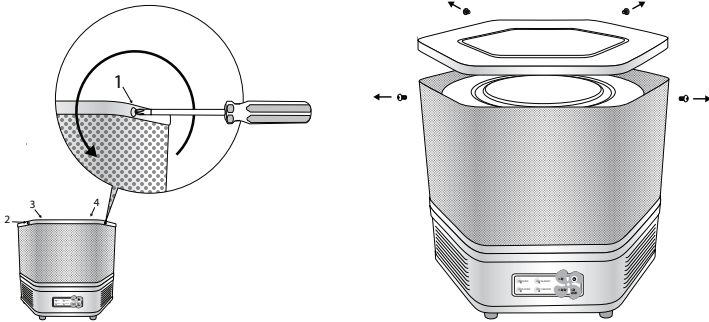

3. Bracing the unit so it does not move, gently press down on the HEPA Cartridge and turn counterclockwise until it unlocks, then lift the HEPA Cartridge out of the Air Filtration System.

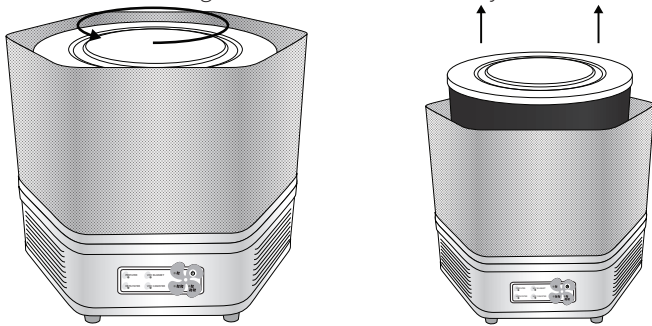

3. Wrap the new Carbon Prefilter around the HEPA Cartridge and secure in place with the aluminum clips.

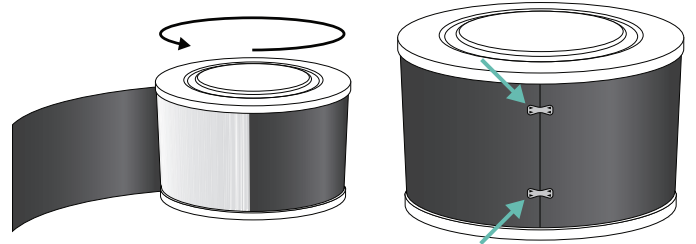

4. Slide the HEPA Cartridge with new Carbon Prefilter back in the center of the unit.

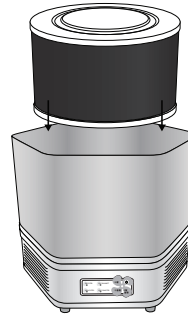

5. Gently press down on the HEPA Cartridge and turn clockwise until it locks into place.

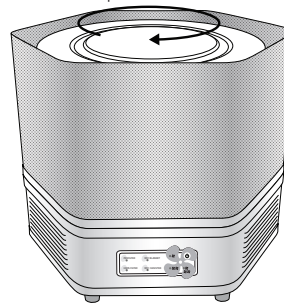

Carbon Prefilter

1. Remove the aluminum clips from the used carbon prefilter, unwrap it from the HEPA Cartridge and discard.

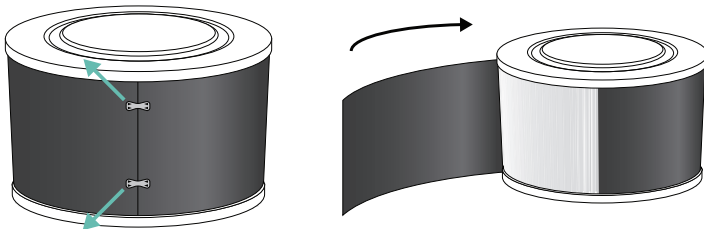

2. Remove plastic packaging from the new Carbon Prefilter.

Carbon Inner Blanket

1. Remove the used Carbon Inner Blanket by curling one end of the filter to the inside. Carefully slide the blanket out from the center of the HEPA Cartridge.

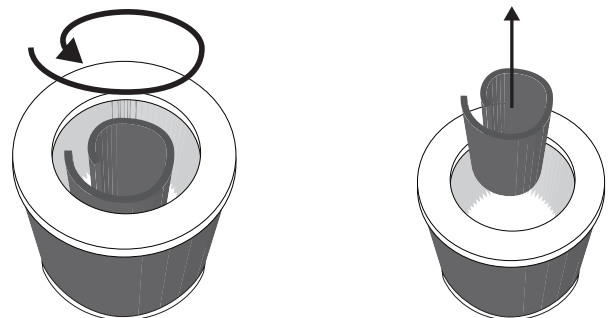

2. Remove the plastic packaging from the new Inner Carbon Blanket.
3. In the opposite direction to which it was rolled in the package, roll the new Carbon Inner Blanket into a cylinder.

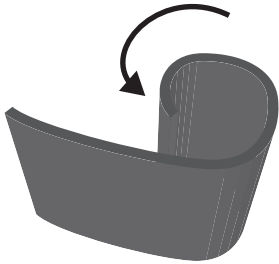

4. Slide the rolled filter into the center of the HEPA Cartridge and lightly press the Carbon Inner Blanket into place against the inside of the HEPA Cartridge.

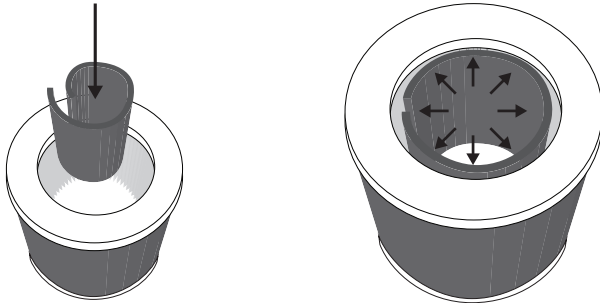

5. Remove the old O-Ring/Gasket from the Venturi inside the unit. Replace with the new O-Ring provided in the Annual Kit.

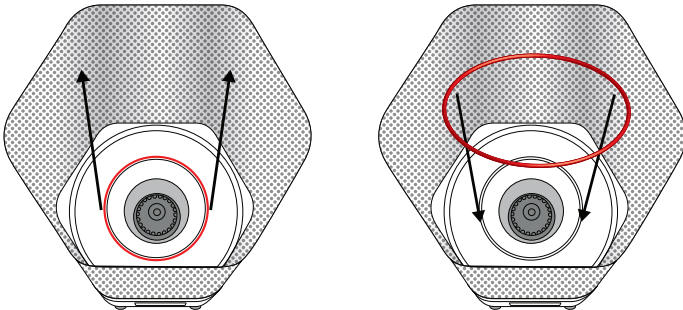

6. Slide the HEPA Cartridge with new Carbon Inner Blanket back in the center of the unit.

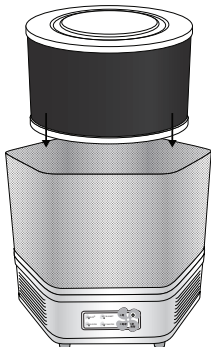

7. Gently press down on the HEPA Cartridge and turn clockwise until it locks into place.

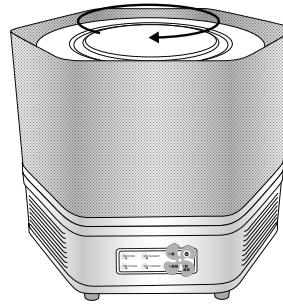

Close the cabinet

1. Position the hexagonal lid on the unit with the centered hole at the rear of the unit.
2. To replace the lid screws, press down firmly on the lid to align the holes and then insert and fasten screws.

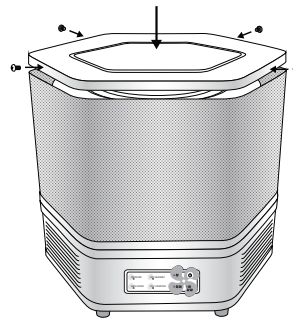

3. Plug the unit in and turn it on.

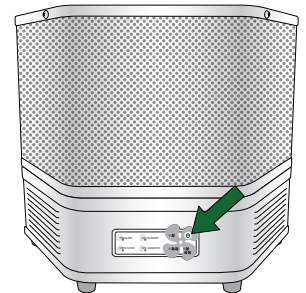
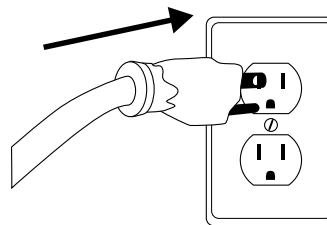

4. To set the Filter Monitors, press and hold the corresponding buttons on the control pad until the blue LEDs illuminate.

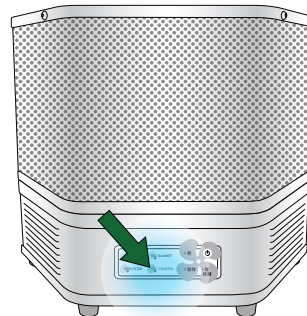

Need help? Call us!

1-800-268-7732

www.amaircare.com Made in Canada
Americaire Corporation 770 Gana Court, Mississauga, Ontario, Canada
 Amaircare is a registered trade mark of Americaire Corporation in the United States and Canada.