

ANNUAL FILTER KIT PLUS



Installing ET style replacement filters in Models 2500 and 3000

Open the cabinet

1. Turn the unit off and unplug it.

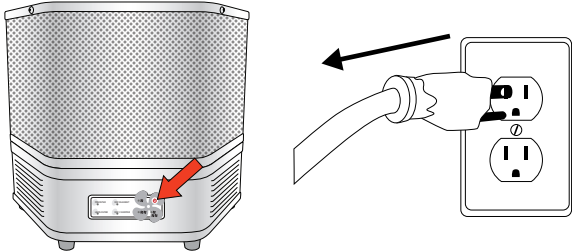

2. Unscrew the 4 lid screws with a No. 2 Phillips screw driver. Once all screws are out, remove the metal lid.

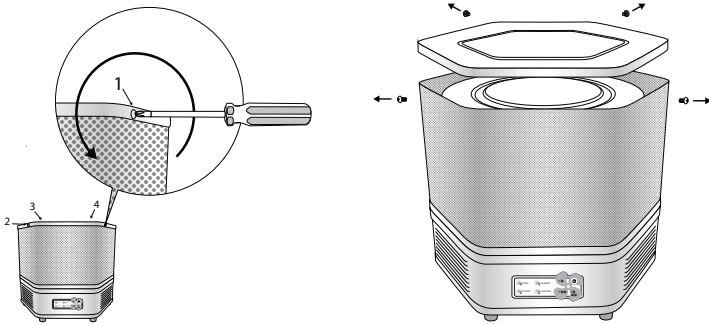

3. Bracing the unit so it does not move, gently press down on the HEPA Cartridge and turn counterclockwise until it unlocks, then lift the HEPA Cartridge out of the Air Filtration System.

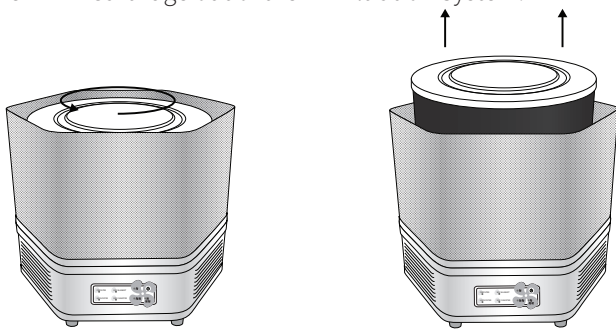

3. Wrap the new Carbon Prefilter around the HEPA Cartridge and secure in place with the aluminum clips.

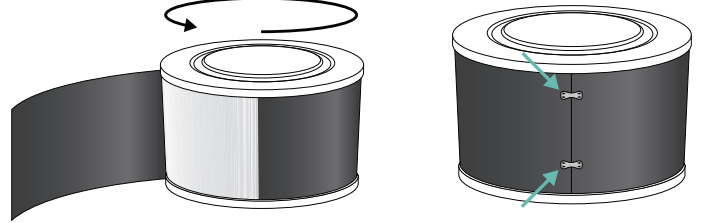

4. Slide the HEPA Cartridge over the V.O.C. Canister and gently down into the Air Filtration System.

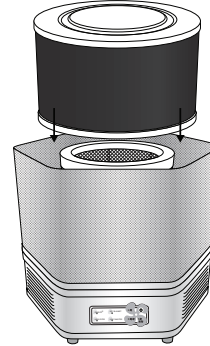

5. Gently press down on the HEPA Cartridge and turn clockwise until it locks into place.

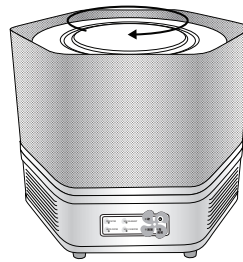

Carbon Prefilter

1. Remove the aluminum clips from the used carbon prefilter, unwrap it from the HEPA Cartridge and discard.

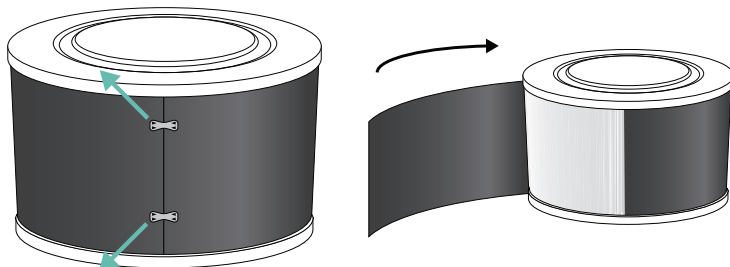

2. Remove plastic packaging from the new Carbon Prefilter.

VOC Canister

1. Remove the plastic packaging from the new V.O.C. Canister.
*If there is a Third Stage Carbon Blanket inside the HEPA Cartridge, carefully remove it and discard.
2. Remove the old O-Ring/Gasket from the Venturi inside the unit. Replace with the new O-Ring provided in the Annual Kit.

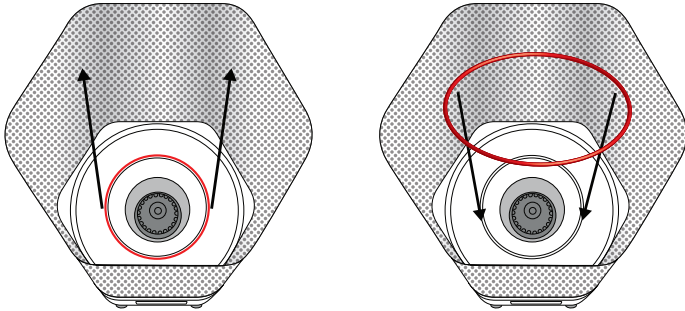

3. Place the V.O.C. Canister inside the Air Filtration System, centered on the intake hole to the motor section. The end of the V.O.C. Canister without the screws is placed down.

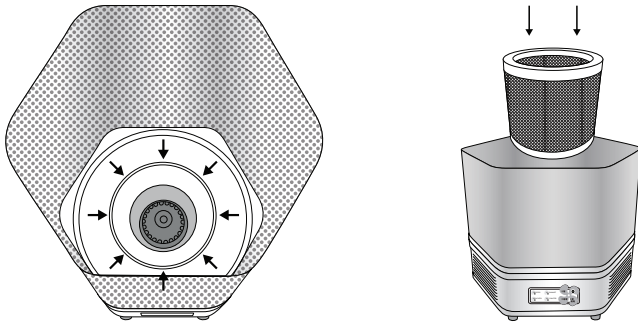

4. Slide the HEPA Cartridge over the V.O.C. Canister and gently down into the Air Filtration System.

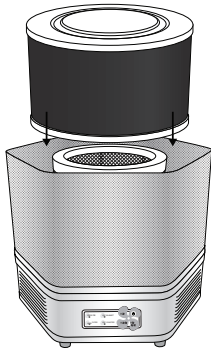

5. Gently press down on the HEPA Cartridge and turn clockwise until it locks into place.

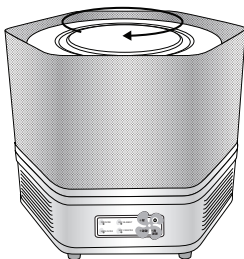

Close the cabinet

1. Position the hexagonal lid on the unit with the centered hole at the rear of the unit.
2. To replace the lid screws, press down firmly on the lid to align the holes and then insert and fasten screws.

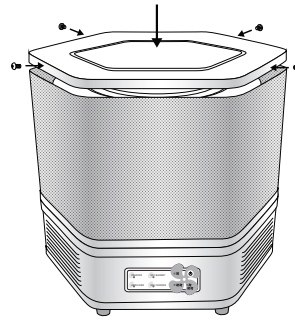

3. Plug the unit in and turn it on.

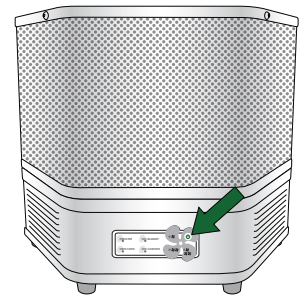
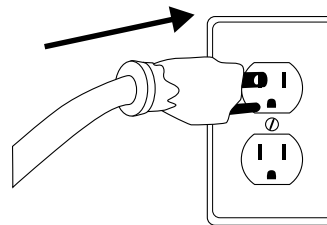

4. To set the Filter Monitors, press and hold the corresponding buttons on the control pad until the blue LEDs illuminate.

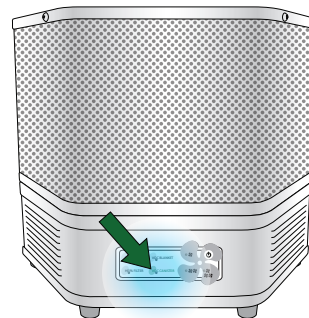

Need help? Call us!

1-800-268-7732

www.amaircare.com **Made in Canada**
Americanair Corporation 770 Gana Court, Mississauga, Ontario, Canada
Amaircare is a registered trade mark of Americanair Corporation in the
United States and Canada.
